

### FEATURES & ADVANTAGES

- ✓ **2,000 LM** max lamp lumen high brightness
- ✓ **100,000+ Hours** long LED lifespan, with professional heat dissipation design
- ✓ **25 Years** long product lifespan
- ✓ **3,000+ Cycles** life LiFePO4 batteries with inbuilt Micro-BMS technologies
- ✓ **99.9%** MPPT tracking efficiency
- ✓ **IP68** rated controller vs. IP66 rated electrical compartment
- ✓ **5+ Days** cloudy/rainy days autonomy
- ✓ **IES Type 1~5** with professional optical designs available to match different project requirements
- ✓ **Flexible & Customized Working Modes** with timer and motion sensor by programming
- ✓ **IoT Control** and online remote monitoring as optional via ZigBee or LoRaWAN



### APPLICATIONS

- ✓ Expressway lighting
- ✓ Street lighting
- ✓ Roadway lighting
- ✓ Public Areas lighting (squares, theme parks, park lots....)



### TECHNICAL SPECIFICATIONS

LED Light Source	Rated Power	12V/ 30W (30LEDsx2 modules)
	LED Brand	PHILIPS 3030 (LED Lumen: 195lm/W)
	Lumens (LM)	1800-2000lm
	Life-span	100,000 hours
	Color Temp. (CCT)	5000K (2700~6500K Full range available)
	CRI	>70
	Viewing Angle	140° (Customized Angles & IES Types Available)
Solar Panel	Power	18V/30Wp (High Efficiency Mono PV)
	Life-span	25 years
Batteries	Capacity/Type	12.8V/12AH (153.6WH) / LiFePO4 Lithium
	Life-span	8+ years (3000 circles @60% DoD)
Controller	Type	MPPT / IP68/IoT Online Monitoring as Optional
	Sensor	Microwave Radar (PIR & Timing as optional)
Full Charge Time	By Solar	5 hours (STC: 1000W/m <sup>2</sup> , 25°C)
Discharge Time	Dim Mode	>75hours
	Bright Mode	>15 hours
Working Temp.	-30°C ~ +80°C	
Mounting Height/Brackets	4~5 m/ Clamp Bracket	
Space Between Lights	18~20m	
Materials	Aluminium Alloy	
Certificate	CE / ROHS / IP66/ IK08/ TÜV-SUD ISO9001/ ISO14001	
Warranty	3 years	

### PERFORMANCE

Power (%)	Lamp Lumens (lm)
100%	2,000
60%	1,200
50%	1,000
30%	600
20%	400

#### Dim with Radar Motion Sensor

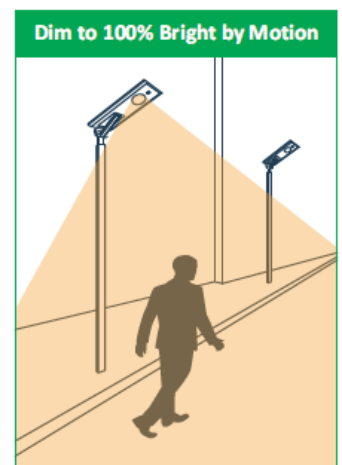
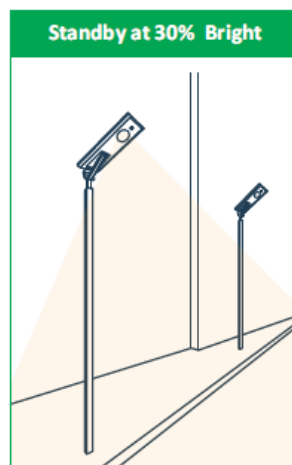

# LED SOLAR STREET LIGHT (ALL IN ONE)

[www.esavior.cn](http://www.esavior.cn)

Model No. ISSL-BRZ-20W

## Dim with Timer

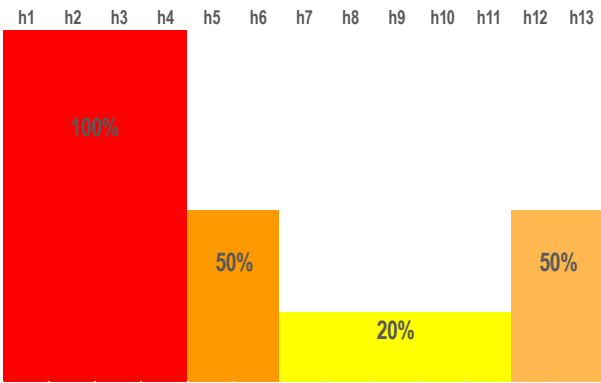

## Dim with Timer+ Motion Sensor

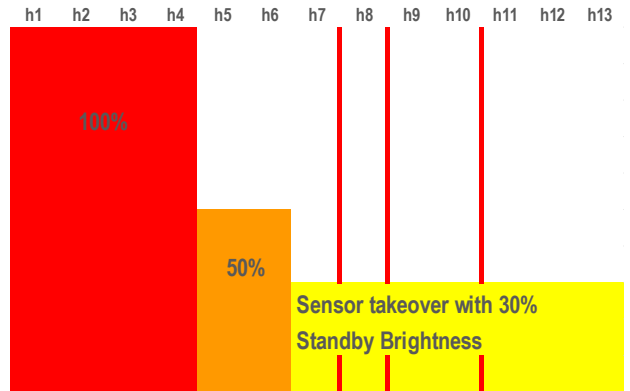

More customized control and working modes for maximum 5 sections available by programming upon customer and project requirements.

## DIMENSIONS

Items	L (mm)	W (mm)	H (mm)	N.W. (kgs)
Light Body	700	292	55	5.5

## PACKING INFORMATION

Items	Package	L (mm)	W (mm)	H (mm)	CBM	G.W. (kgs)
Light Body	2pcs per Carton	735	350	175	0.045	13.0
Mounting Brackets	8pcs per Carton	380	320	230	0.028	16.0
PCS/40'HQ Container:	1700 pcs	PCS/20' Container		1200 pcs		

## ACCESSORIES

Clamp bracket for Wall or Pole , Arm Brackets for Pole Mounting Available.

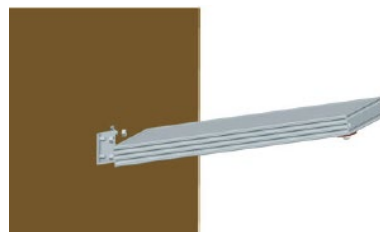

**PHILIPS**



### DISTRIBUTIONS & IES TYPE

IES Type II as regular distribution, customized IES Types available upon requirements

#### Luminous Intensity Distribution Curve

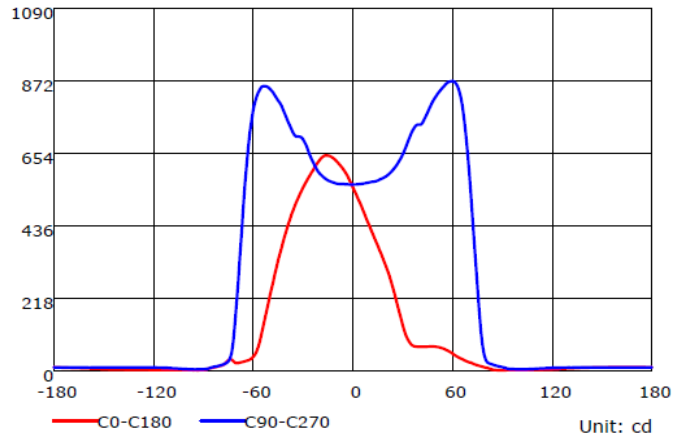
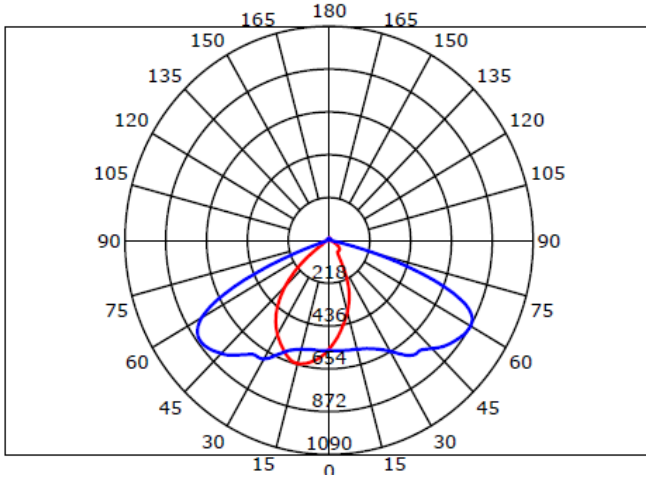

#### Illuminance at a Distance

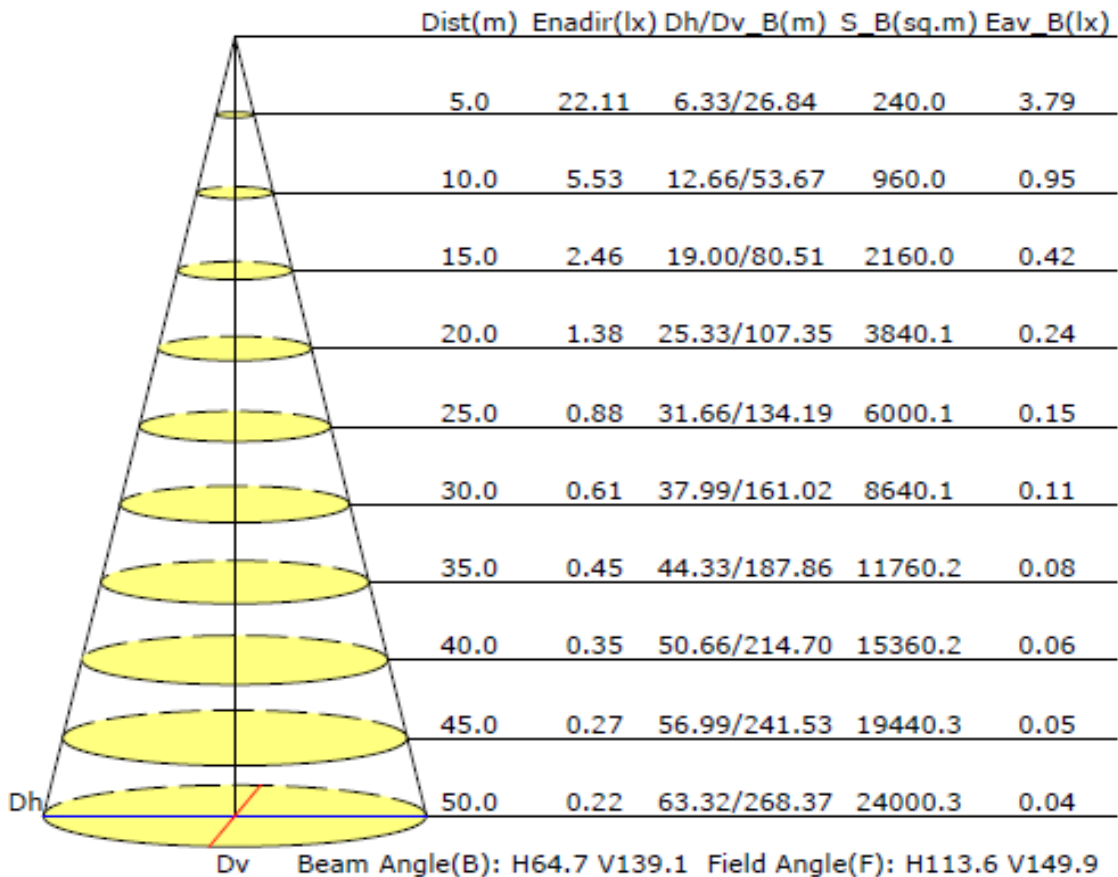

### DIALUX SIMULATION REPORT

Street Profile: ( Tarmac: R3, q0: 0.070)

Pole Height :5m ; Road Width: 5m; Pole Distance :18m; Lanes: 1;

### Luminaire Arrangements

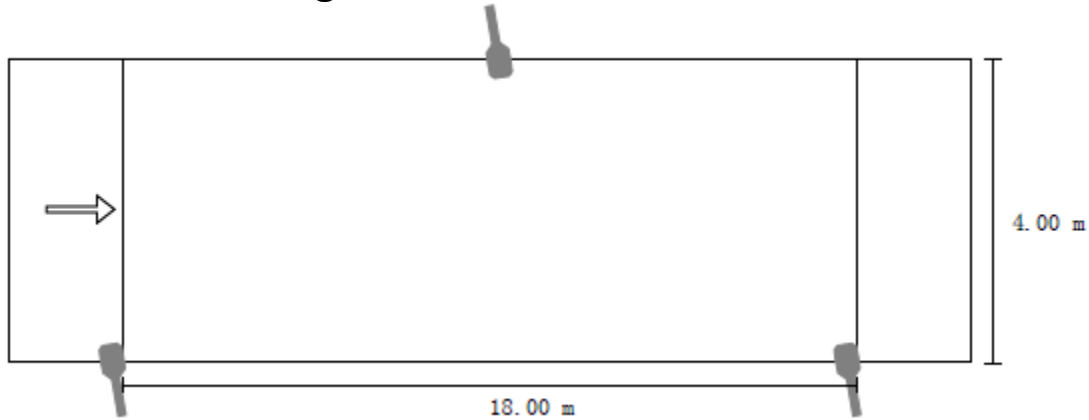

### Valuation Field Roadway / Isolines (E)

